

REP-ESE18^②

EARLY STREAMER EMISSION AIR TERMINAL (ESE)

Type **REP-ESE18^②**

Characteristics

Efficiency	ΔT	20 μ s
Standard deviation ESE / Single rod	σ	$\sigma_{PDA} < 0.4\sigma_{pts}$
Lightning current withstanding test (10/350 μ s)	I_{imp}	100kA
Max. current withstanding test (8/20 μ s)	I_{max}	200 kA
Upward pole	3	
Down pole	3	
Net Weight	3.5kg	

Operating principle

Detection of download leader	Continuous measuring of electric field gradient
Upward streamer emission	Sparking by High Voltage Impulse
Internal circuits	3 independent circuits
Central rod	Stainless Steel 304, Φ 20mm
Metal housing	Stainless Steel 304
On-site testing capabilities	REP-ESE TESTER
Maintenance	No need to connect the power source
Warranty	10 years

Mechanical specifications

Fixing on pole	M20 Thread
Down conductor connection	Adapter (optional) Clamp

Packaging

Dimensions	402 x220 x220
Contents	ESE Instruction
Gross Weight	5KG
Environmental sustainability	100% recyclable

Certifications

NF C 17 102:2011, Annexe C	Beijing Testing Center Of Surge Protection Device No.2008-(ESE)-003J14
ISO 9001 : 2008	NO.:04914Q10660R3M
Part No.	621160



REP-ESE18^②

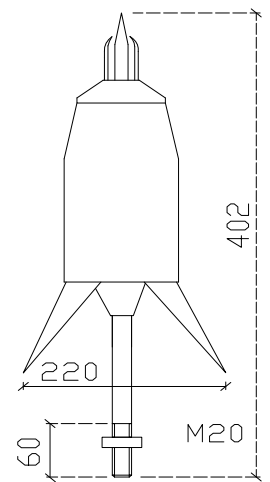

Dimensions(mm)

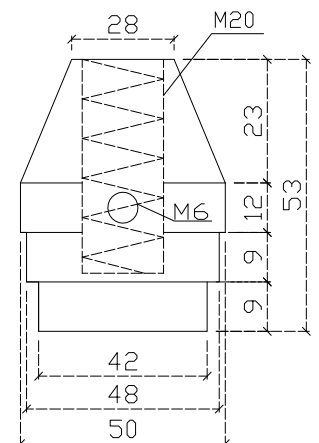

Adapter